

# LINEAR INDUSTRY LUMINAIRE IP65

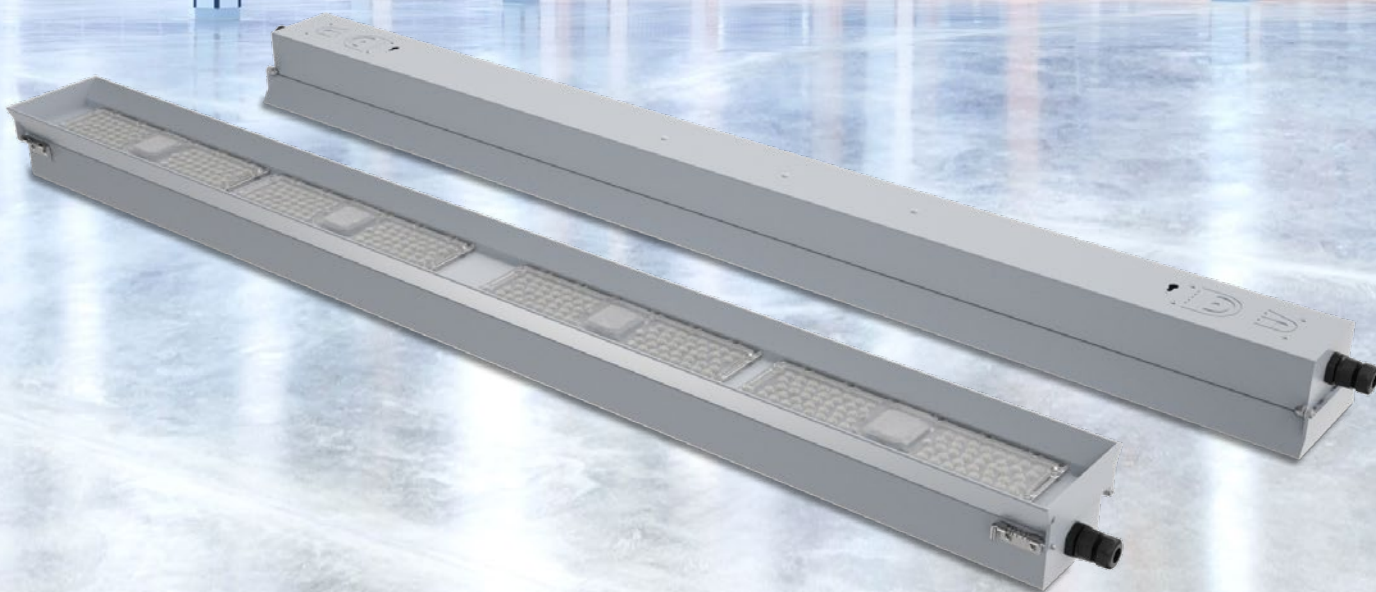

## Product Information

Versatile Linear Industry Luminaire offers high-performance, low-glare illumination, ideal for industrial and hall applications. It supports flexible installation such as ceiling-mounted, wire-suspended, or using custom brackets for sloped surfaces. Rated IP65 for durability, it's also sustainably designed following global EPD standards. Both the driver and LED components are easily replaceable for simple maintenance.

## Product Feature

- Sustainable Design;
- Flexible Installation;
- 60/90/70\*145 Beam Angle for choice;
- Plug & Play Wire Connection;
- Easy Replacement of LED Board and Driver;
- Wiring Through Upon Request.



plug&play



IP65



IK10



Wiring  
Through



Sustainable

# Datasheet

Product Code	LS120WWP1200	LS150WWP1500
Dimension	1200 × 110 × 80MM	1500 × 110 × 80MM
Power Consumption	120W	150W
LED Quantity	336pcs	420pcs
Luminaire Efficacy	140LM / W	140LM / W
Led Spec.	LM80 approved 2835LED	
CCT	4000K / 5000K / 6000K	
CRI	>80	
SDCM	<3	
Beam Angle	60 / 90 / 70*145 Degree	
Driver Brand	ENEC Certified IP67 Driver	
Input Voltage	AC220 ~ 240V	
Power Factor	>0.95	
IP Rate & IK Rate	IP65&IK10	
Working Temp	-25°C ~ 45°C	
L90 Lifespan	>50,000 Hours	
Warranty	5 Years	

## Dimensions (mm)

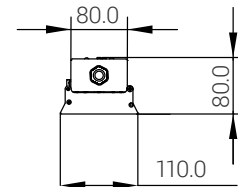
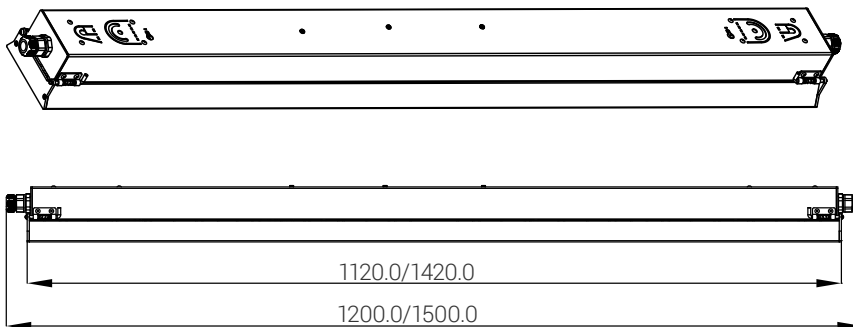

## Packaging

Product Code	LS120WWP1200	LS150WWP1500
Carton Size	126*34*14CM	156*34*14CM
Weight	11.95KG	16.24KG
Qty./Ctn.	2 Pieces	2 Pieces